

Service kit

Pos	Qtà
14.06	1
14.16	1
14.20	1
28.04	1
36.00	1
36.51* 1	
73.00	1
81.00	1
94.00	1

*Quando presente
When available

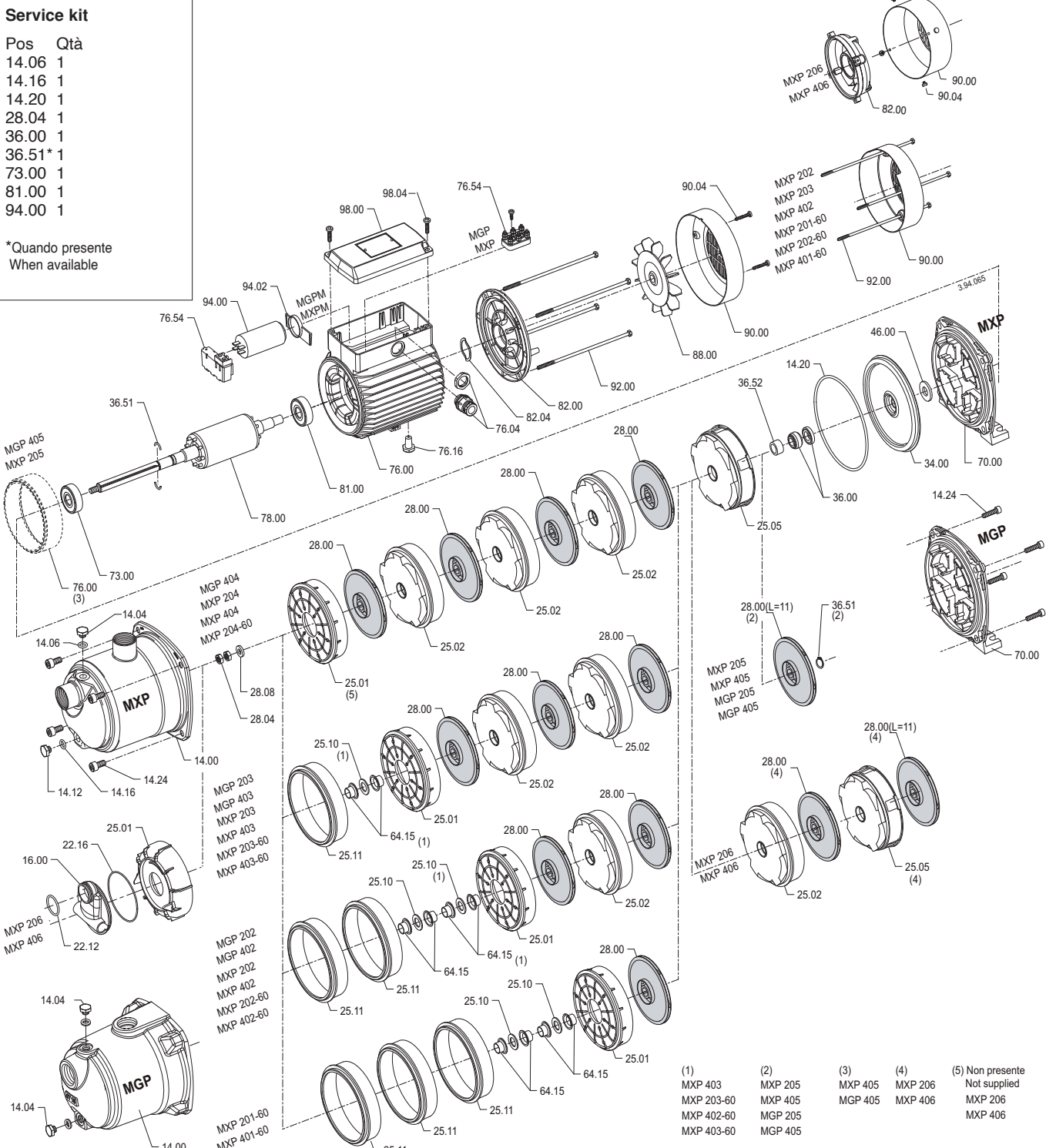

- | | | | | |
|------------|---------|---------|---------|------------------|
| (1) | (2) | (3) | (4) | (5) Non presente |
| MXP 403 | MXP 205 | MXP 405 | MXP 206 | Not supplied |
| MXP 203-60 | MXP 405 | MGP 405 | MXP 406 | MXP 206 |
| MXP 402-60 | MGP 205 | | | MXP 406 |
| MXP 403-60 | MGP 405 | | | |